



Electrostart

STARTS UP THE LIGHT

LED'S START UP THE LIGHT

LED

PRODUCTS

Applicable for office, household, street, architectural, decorative and advertising lighting

PRODUCTOS

Aplicable para iluminación de oficinas, hogares, calles, arquitectónica, decorativa y publicitaria

LED

Wide Body LED Panel

LED Panel Cuerpo Ancho

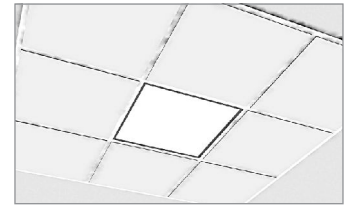
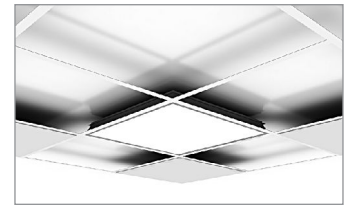
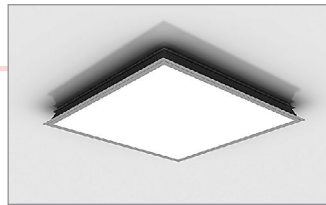

ENG

Ingress Protection IP20
Ambient Temp -10~40 °C
Flickering 0%
Over temperature protection Yes
Safety Class II (I for built-in)
Marking CE, ENEC if required

ES

Grado de protección IP20
Temperatura ambiente -10~40 °C
Parpadeo 0%
Protección contra sobretensión Sí
Clase de seguridad II (a incorporar Clase I)
Marcado CE, ENEC si se requiere

IP20
-10~40 °C
0%
Sí
CE, ENEC si se requiere

Panel built-in driver

Supply voltage VAC	Frequency	Rated power	Power factor	Ingress protection (IP)	Colour rendering index	Colour temperature	Luminous flux	Material of the body	Material of the diffuser	Length (mm)	Width (mm)	Height (mm)	Lifetime	Warranty
176-240	50/60 Hz	36W	>0.90	IP20	Ra ≥ 80	3000/4000K	3 600 lm	Aluminium / Plastic	PMMA	595	595	50	30 000 h	3 Y
176-240	50/60 Hz	40W	>0.90	IP20	Ra ≥ 80	3000/4000K	4 000 lm	Aluminium / Plastic	PMMA	595	595	50	30 000 h	3 Y
176-240	50/60 Hz	46W	>0.90	IP20	Ra ≥ 80	3000/4000K	4 600 lm	Aluminium / Plastic	PMMA	595	595	50	30 000 h	3 Y

Panel separate driver

Supply voltage VAC	Frequency	Rated power	Power factor	Ingress protection (IP)	Colour rendering index	Colour temperature	Luminous flux	Material of the body	Material of the diffuser	Length (mm)	Width (mm)	Height (mm)	Lifetime	Warranty
176-240	50/60 Hz	36W	>0.90	IP20	Ra ≥ 80	3000/4000K	4 320 lm	Aluminium / Plastic	PMMA	595	595	50	30 000 h	3 Y
176-240	50/60 Hz	40W	>0.90	IP20	Ra ≥ 80	3000/4000K	4 800 lm	Aluminium / Plastic	PMMA	595	595	50	30 000 h	3 Y
176-240	50/60 Hz	46W	>0.90	IP20	Ra ≥ 80	3000/4000K	5 520 lm	Aluminium / Plastic	PMMA	595	595	50	30 000 h	3 Y

Slim LED Panel

LED Panel Delgado



ENG

Ingress Protection IP20
Ambient Temp -10~40 °C
Flickering 0%
Over temperature protection Yes
Safety Class II
Marking CE, ENEC if required

ES

Grado de protección IP20
Temperatura ambiente -10~40 °C
Parpadeo 0%
Protección contra sobretensión Sí
Clase de seguridad II
Marcado CE, ENEC si se requiere

IP20
-10~40 °C
0%
Sí
CE, ENEC si se requiere

Slim

Supply voltage VAC	Frequency	Rated power	Power factor	Ingress protection (IP)	Colour rendering index	Colour temperature range options	Luminous flux	Material of the body	Material of the diffuser	Length (mm)	Width (mm)	Height (mm)	Lifetime	Warranty
220-240	50/60 Hz	36W	>0.90	IP20	Ra ≥ 80	3000-3500k	3050 lm	Aluminium	PMMA	595	595	9	30 000 h	3 Y
220-240	50/60 Hz	36W	>0.90	IP20	Ra ≥ 80	4000-4500k	3050 lm	Aluminium	PMMA	595	595	9	30 000 h	3 Y
220-240	50/60 Hz	36W	>0.90	IP20	Ra ≥ 80	6000-6500k	3050 lm	Aluminium	PMMA	595	595	9	30 000 h	3 Y
220-240	50/60 Hz	48W	>0.90	IP20	Ra ≥ 80	3000-3500k	4050 lm	Aluminium	PMMA	595	595	9	30 000 h	3 Y
220-240	50/60 Hz	48W	>0.90	IP20	Ra ≥ 80	4000-4500k	4050 lm	Aluminium	PMMA	595	595	9	30 000 h	3 Y
220-240	50/60 Hz	48W	>0.90	IP20	Ra ≥ 80	6000-6500k	4050 lm	Aluminium	PMMA	595	595	9	30 000 h	3 Y
220-240	50/60 Hz	72W	>0.90	IP20	Ra ≥ 80	3000-3500k	6150 lm	Aluminium	PMMA	595	595	9	30 000 h	3 Y
220-240	50/60 Hz	72W	>0.90	IP20	Ra ≥ 80	4000-4500k	6150 lm	Aluminium	PMMA	595	595	9	30 000 h	3 Y
220-240	50/60 Hz	72W	>0.90	IP20	Ra ≥ 80	6000-6500k	6150 lm	Aluminium	PMMA	595	595	9	30 000 h	3 Y

Linear Fixture

Luminaria lineal

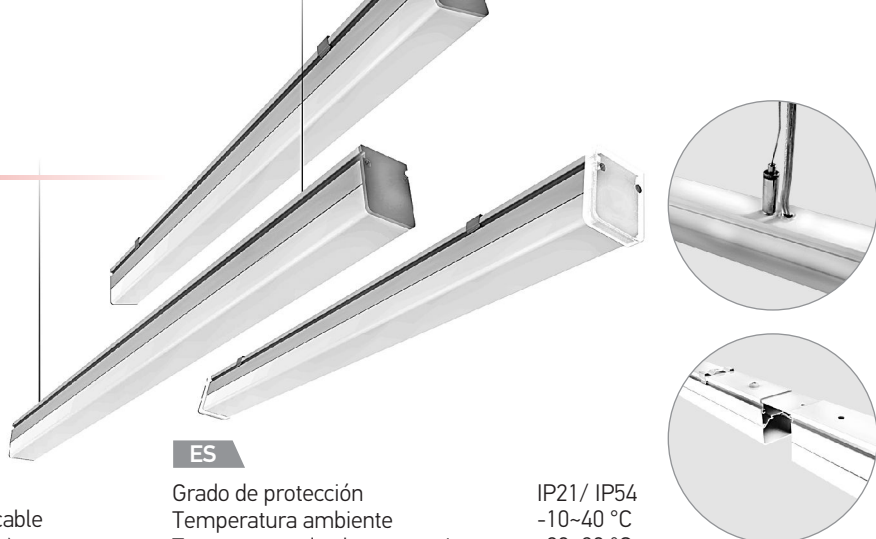

ENG

Ingress Protection IP21/ IP54
 Ambient Temp -10~40 °C
 Storage Temp -20~80 °C
 Light Distribution Direct
 Cable Supplied with white cable (3x0.5mm² L=600mm)

Non Dimmable
 Over temperature protection Yes
 Safety Class II
 Protection No UV and IR Light
 Marking CE, ENEC if required

ES

Grado de protección IP21/ IP54
 Temperatura ambiente -10~40 °C
 Temperatura de almacenamiento -20~80 °C
 Distribución de luz Directa
 Cable Se suministra con cable blanco (3x0.5mm² L=600mm)

No regulable
 Protección contra sobretemperatura Sí
 Clase de seguridad II
 Protección Sin Luz UV e IR
 Marcado CE, ENEC si se requiere

Linear

Supply voltage	Frequency	Rated power	Power factor	Ingress protection (IP)	Colour rendering index	Colour temperature	Luminous flux	Material of the body	Material of the diffuser	Length (mm)	Width (mm)	Height (mm)	Lifetime	Warranty
170-240 V	50/60 Hz	10W	>0.95	IP21/ IP54	Ra ≥ 80	3000/4000k	1100 lm	Aluminium	PMMA / PC	586	31	42	30 000 h	3 Y
170-240 V	50/60 Hz	12W	>0.95	IP21/ IP54	Ra ≥ 80	3000/4000k	1350 lm	Aluminium	PMMA / PC	874	31	42	30 000 h	3 Y
170-240 V	50/60 Hz	18W	>0.95	IP21/ IP54	Ra ≥ 80	3000/4000k	2100 lm	Aluminium	PMMA / PC	1162	31	42	30 000 h	3 Y
170-240 V	50/60 Hz	28W	>0.95	IP21/ IP54	Ra ≥ 80	3000/4000k	3250 lm	Aluminium	PMMA / PC	1450	31	42	30 000 h	3 Y

LED Sets

Equipos LED

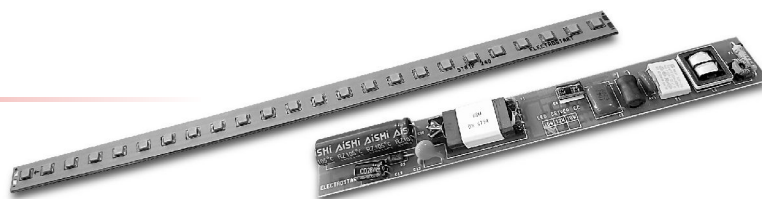

ENG

SETS AND PROJECT BASED SOLUTIONS

Electrostart JSCo has always been close to its customers. Since we want to present a working solution to our partners, we have started to work for Projects and present a final complete solutions as per request.

When completing a certain project, the product is included in our portfolio as a SET and as well separately to be ordered. Thus we develop our product range and can present more different types of solutions in order to satisfy the customers' needs.

The above presented products can be ordered separately and as a complete Set.

ES

EQUIPOS LED Y SOLUCIONES BASADAS EN PROYECTOS

Electrostart JSCo siempre ha estado cerca de sus clientes. Para poder satisfacer las necesidades de nuestros clientes, hemos empezado a trabajar sobre Proyectos concretos, ofreciendo soluciones completas basadas en los requerimientos de nuestros clientes.

Al finalizar un proyecto concreto, incluimos el producto en nuestro portafolio como equipo, con la posibilidad de ser ordenado por separado también. Así desarrollamos nuestra gama de productos y podemos ofrecer distintas soluciones a nuestros clientes con el fin de satisfacer sus necesidades.

Los productos arriba presentados pueden ser ordenados por separado o como equipos completos.

LED Driver Constant Current

Model type	Art. Nº	Mains voltage V	Input Voltage Range, V	Nominal Current at 230 VAC A	Mains frequency Hz	Power Factor	Rated Output Power (at 230VAC/50Hz) W	Efficiency (at 230VAC/50Hz)	DC voltage range V	Output current A	Operating temperature range, °C	Dimmability	Dimensions mm
LED 10W CC	9800010000	110 ÷ 240V AC	80 ÷ 270V AC	0.047	50/60	≥ 0.95	9	≥ 0.85	30÷40	0.24	-10 ÷ 40	not dimmable	171 x 20
LED 12W CC	9800012000	110 ÷ 240V AC	80 ÷ 270V AC	0.061	50/60	≥ 0.95	11,4	≥ 0.85	30÷40	0.315	-10 ÷ 40	not dimmable	171 x 20
LED 18W CC	9800018000	110 ÷ 240V AC	80 ÷ 270V AC	0.082	50/60	≥ 0.95	16	≥ 0.85	30÷40	0.43	-10 ÷ 40	not dimmable	171 x 20
LED 28W CC	9800028000	110 ÷ 240V AC	80 ÷ 270V AC	0.14	50/60	≥ 0.95	22	≥ 0.85	30÷40	0.722	-10 ÷ 40	not dimmable	195 x 20

LED Strips

Model type	Art. Nº	Input Voltage	Input Current	Luminous efficacy	Color Temperature	Nominal LED Current (Power)	Ambient temperature range, Ta	Viewing angle	Dimensions of LED strip mm	Number of LED strips
LED 10W Strip	9820010000	35V - 37V	120mA	150lm/W	3000K; 4000K	60mA (0,2W)	-10°C ÷ 40°C	120 Deg	288x9.9x1	2
LED 12W Strip	9820012000	35V - 37V	120mA	150lm/W	3000K; 4000K	60mA (0,2W)	-10°C ÷ 40°C	120 Deg	288x9.9x1	3
LED 18W Strip	9820018000	35V - 37V	120mA	150lm/W	3000K; 4000K	60mA (0,2W)	-10°C ÷ 40°C	120 Deg	288x9.9x1	4
LED 28W Strip	9820028000	35V - 37V	120mA	150lm/W	3000K; 4000K	60mA (0,2W)	-10°C ÷ 40°C	120 Deg	240x9.9x1	6

Constant Current LED driver

LED driver de Corriente Constante



ENG

Characteristics

- Independent type
- Suitable for many types of luminaries
- Safety class II
- Degree of protection IP20
- SELV equivalent
- Protection against output short circuit
- Protection against no load operation
- Integrated over temperature protection
- Excellent protection against transient main peaks
- Not dimmable
- Series with ripple <30%
- Failure rate <0,02% per 1 000 hrs

ES

Características

- Tipo independiente
- Conveniente para muchos tipos de luminarias
- Clase de protección II
- Grado de protección IP20
- SELV equivalente
- Protección contra cortocircuito de la salida
- Protección contra operación ninguna de carga
- Protección térmica incorporada
- Excelente protección contra picos transitorios de la red
- No regulable
- Serie con ripple <30%
- Tasa de fallas <0.2% por 1000 horas

Constant Current type

Model type	Art. №	Mains voltage, VAC 50/60Hz	Input Voltage Range VAC	Nominal Current A	Power Factor	Output Current mA	Output Voltage V	Output current ripple %	Output Power W	Efficiency %	Ambient Temperature °C	Tc max °C	Wire Range mm ²	Weight g	Dimensions mm
LED-350-7W	980007035001	220-240	198-264	0.070/230VAC	≥ 0.50	350	8...20	ripple free	7	85	-20 ÷ +50	75	0.75 ÷ 1.5	68±5	120.6x39.6x30.5
LED-350-9W	980009035001	220-240	198-264	0.090/230VAC	≥ 0.50	350	10...25.8	ripple free	9	84	-20 ÷ +50	75	0.75 ÷ 1.5	68±5	120.6x39.6x30.5
LED-350-12W	980012035001	220-240	198-264	0.118/230VAC	≥ 0.50	350	10...36	ripple free	12.6	84	-20 ÷ +50	75	0.75 ÷ 1.5	68±5	120.6x39.6x30.5
LED-700-12W	980012070001	220-240	198-264	0.125/230VAC	≥ 0.50	700	5...18	ripple free	12.6	82	-20 ÷ +45	75	0.75 ÷ 1.5	68±5	120.6x39.6x30.5
LED-350-14W	980014035001	220-240	198-264	0.130/230VAC	≥ 0.50	350	15...40	ripple free	14	84	-20 ÷ +50	80	0.75 ÷ 1.5	68±5	120.6x39.6x30.5
LED-700-14W	980014070001	220-240	198-264	0.140/230VAC	≥ 0.50	700	9...20	ripple free	14	80	-20 ÷ +45	75	0.75 ÷ 1.5	68±5	120.6x39.6x30.5
LED-350-16W	980016035001	220-240	198-264	0.150/230VAC	≥ 0.50	350	20...48	ripple free	16.8	85	-20 ÷ +45	80	0.75 ÷ 1.5	68±5	120.6x39.6x30.5
LED-700-16W	980016070001	220-240	198-264	0.160/230VAC	≥ 0.50	700	13...24	ripple free	16.8	82	-20 ÷ +45	75	0.75 ÷ 1.5	68±5	120.6x39.6x30.5
LED-700-16W	980070002402	100-240	90-264	0.150/240VAC	≥ 0.50	700	6...24	5%	16	84	-10 ÷ +40	75	-	64±5	109x34.2x25.8
LED-350-20PW	980020035001	200-240	180-264	0.107/230VAC	≥ 0.97	350	36...60	16%	21	88	-20 ÷ +45	80	0.75 ÷ 1.5	80±5	120.6x39.6x30.5
LED-700-20PW	980020070001	200-240	180-264	0.107/230VAC	≥ 0.96	700	16...29.5	10%	20.7	87	-20 ÷ +50	80	0.75 ÷ 1.5	80±5	120.6x39.6x30.5
LED-700-22PW	980022070003	200-240	180-264	0.113/230VAC	≥ 0.96	700	24...32	8%	22.4	89	-20 ÷ +50	70°C	0.75 ÷ 1.5	95±5	120.6x39.6x30.5
LED-350-25PW	980025035001	200-240	180-264	0.126/230VAC	≥ 0.97	350	57...73	17%	25.55	89	-20 ÷ +40	75	0.75 ÷ 1.5	80±5	120.6x39.6x30.5
LED-700-25PW	980025070001	200-240	180-264	0.130/230VAC	≥ 0.97	700	22...36.6	15%	25.6	88	-20 ÷ +40	75	0.75 ÷ 1.5	80±5	120.6x39.6x30.5
LED-350-30PW	980030035001	200-240	180-264	0.150/230VAC	≥ 0.98	350	57...88	14%	30.8	90	-20 ÷ +40	80	0.75 ÷ 1.5	80±5	120.6x39.6x30.5
LED-700-30PW	980030070001	200-240	180-264	0.152/230VAC	≥ 0.98	700	20...44	15%	30.8	88	-20 ÷ +40	75	0.75 ÷ 1.5	80±5	120.6x39.6x30.5
LED-1050-30PW	980030105001	200-240	180-264	0.154/230VAC	≥ 0.98	1050	19...29.6	12%	31	89	-20 ÷ +40	80	0.75 ÷ 1.5	85±5	120.6x39.6x30.5
LED-700-35PW	980035070001	200-240	180-264	0.177/230VAC	≥ 0.98	700	22...51.5	15%	36	90	-20 ÷ +40	80	0.75 ÷ 1.5	90±5	120.6x39.6x30.5
LED-700-35PW	980035070003	200-240	180-264	0.175/230VAC	≥ 0.97	700	26...51.5	14%	36	90	-20 ÷ +40	75°C	0.75 ÷ 1.5	100±5	120.6x39.6x30.5
LED-1050-35PW	980035105001	200-240	180-264	0.178/230VAC	≥ 0.98	1050	23...34.3	21%	36	89	-20 ÷ +35	75	0.75 ÷ 1.5	90±5	120.6x39.6x30.5
LED-850-36PW	980036085001	200-240	180-264	0.181/230VAC	≥ 0.97	850	29...42.6	15%	36.2	89	-20 ÷ +40	80	0.75 ÷ 1.5	90±5	120.6x39.6x30.5
LED-900-36PW	980036090001	200-240	180-264	0.180/230VAC	≥ 0.97	900	25...40.9	17%	36.8	90	-20 ÷ +40	85	0.75 ÷ 1.5	90±5	120.6x39.6x30.5
LED-900-37PW	980037090001	200-240	180-264	0.180/230VAC	≥ 0.98	900	25...42	18%	37.8	90	-20 ÷ +40	85	0.75 ÷ 1.5	90±5	120.6x39.6x30.5
LED-950-38PW	980038095001	200-240	180-264	0.188/230VAC	≥ 0.98	950	30...40	19%	38	89	-20 ÷ +35	80	0.75 ÷ 1.5	90±5	120.6x39.6x30.5
LED-700-40PW	980040070001	200-240	180-264	0.200/230VAC	≥ 0.98	700	26...58	14%	40.6	90	-20 ÷ +40	85	0.75 ÷ 1.5	90±5	120.6x39.6x30.5
LED-700-40PW	980040070003	200-240	180-264	0.196/230VAC	≥ 0.98	700	26...58	14%	40.6	90	-20 ÷ +45	90°C	0.75 ÷ 1.5	100±5	120.6x39.6x30.5
LED-1050-40PW	980040105001	200-240	180-264	0.205/230VAC	≥ 0.97	1050	24...39.6	17%	41.5	90	-20 ÷ +35	80	0.75 ÷ 1.5	90±5	120.6x39.6x30.5
LED-1000-42PW	980042100001	200-240	180-264	0.208/230VAC	≥ 0.98	1000	27...42.6	18%	42.6	89	-20 ÷ +35	80	0.75 ÷ 1.5	90±5	120.6x39.6x30.5
LED-1050-42PW	980042105001	200-240	180-264	0.210/230VAC	≥ 0.98	1050	22...40.6	19%	42.6	89	-20 ÷ +30	80	0.75 ÷ 1.5	90±5	120.6x39.6x30.5
LED-1050-45PW	980045105001	200-240	180-264	0.222/230VAC	≥ 0.98	1050	22...43.8	18%	46	90	-20 ÷ +30	80	0.75 ÷ 1.5	90±5	120.6x39.6x30.5

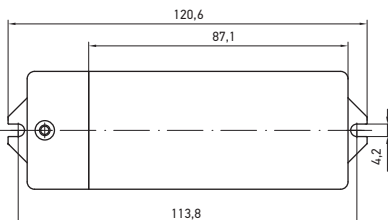

Diagrams / Diagramas

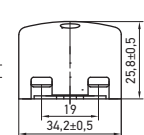
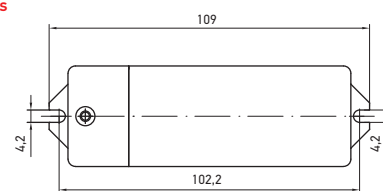
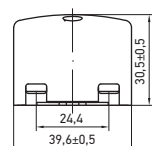

Wiring diagrams

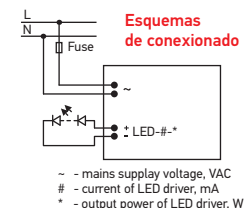

Constant Voltage LED driver

LED driver de Voltaje Constante



ENG Characteristics

- Independent type
- Suitable for many types of luminaires
- Safety class II
- Degree of protection IP20 (for indoor use)
- SELV equivalent
- Protection against output short circuit
- Protection against no load operation
- Integrated over temperature protection
- Excellent protection against transient main peaks
- Not dimmable
- Failure rate <0.02% per 1 000 hrs

ES Características

- Tipo independiente
- Conveniente para muchos tipos de luminarias
- Clase de protección II
- Grado de protección IP20 (sólo para uso en interiores)
- SELV equivalente
- Protección contra cortocircuito de la salida
- Protección contra operación ninguna de carga
- Protección térmica incorporada
- Excelente protección contra picos transitorios de la red
- No regulable
- Tasa de fallas <0.2% por 1000 horas

Constant Voltage type

Model type	Art. Nº	Mains voltage, VAC 50/60Hz	Input Voltage Range VAC	Nominal Current A	Power Factor	Output Voltage VDC	Output Current A	Output Power W	Efficiency %	Ambient Temperature °C	Tc max °C	Weight g	Dimensions mm
LED-12V CV-12W	980012012002800	100-240	90-264	0.150/240VAC	≥ 0.50	12	0...1	12	83	-10 ÷ +40	75	64±5	109x34.2x25.8
LED-12-25PW	980025001200364	220-240	198-264	0.138/230VAC	≥ 0.95	12	0...2.166	26	86	-20 ÷ +40	85	100±5	120.6x39.6x30.5
LED-24V CV-12W	980012024002802	100-240	90-264	0.150/240VAC	≥ 0.50	24	0...0.5	12	84	-10 ÷ +40	70	64±5	109x34.2x25.8
LED-24-25PW	980025002400366	200-240	180-264	0.125/230VAC	≥ 0.96	24	0...1.042	25	89	-20 ÷ +45	85	100±5	120.6x39.6x30.5
LED-24-35PW	980035002400362	200-240	180-264	0.125/230VAC	≥ 0.93	24	0...1.458	35	90	-20 ÷ +40	85	100±5	120.6x39.6x30.5

Constant Voltage Power Supply type IP68 High Power

Fuentes de Alimentación de Voltaje Constante tipo IP68

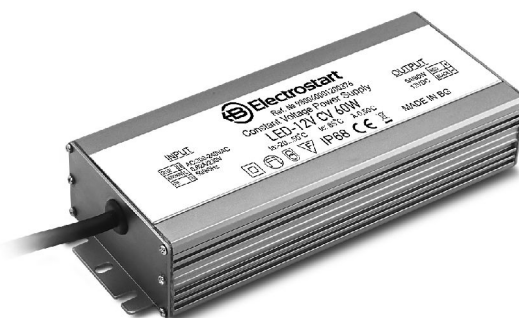

Model type	Art. Nº	Mains voltage, VAC 50/60Hz	Input Voltage Range VAC	Nominal Current A	Power Factor	Output Voltage VDC	Output Current A	Output Power W	Efficiency %	Ambient Temperature °C	Tc max °C	Weight g	Dimensions mm
LED-12V CV 60W	980060001200376	200-240	180-264	0.62/230VAC	≥ 0.50	12	5	60	84	-20 ÷ +50	85	350±5	170.5x42x38
LED-24V CV 60W	980060002400378	200-240	180-264	0.62/230VAC	≥ 0.50	24	2.5	60	85	-20 ÷ +50	85	350±5	170.5x42x38
LED-12V CV 100W	980100001200380	200-240	180-264	1.02/230VAC	≥ 0.50	12	8.33	100	86	-20 ÷ +50	85	760±5	198.6x61.5x36.8
LED-24V CV 100W	980100002400382	200-240	180-264	1.02/230VAC	≥ 0.50	24	4.15	100	87	-20 ÷ +50	85	760±5	198.6x61.5x36.8
LED-12V CV 150W	980150001200384	200-240	180-264	1.47/230VAC	≥ 0.50	12	12.5	150	89	-20 ÷ +50	85	1040±5	223x68x38
LED-24V CV 150W	980150002400386	200-240	180-264	1.47/230VAC	≥ 0.50	24	6.25	150	90	-20 ÷ +50	85	1040±5	223x68x38
LED-12V CV 200W	980200001200388	200-240	180-264	1.96/230VAC	≥ 0.50	12	16.6(12.49@50°C)	200	89	-20 ÷ +50	85	1050±5	231x68x38.8
LED-24V CV 200W	980200002400390	200-240	180-264	1.96/230VAC	≥ 0.50	24	8.4(6.3@50°C)	200	90	-20 ÷ +50	85	1050±5	231x68x38.8

ENG

IP Protection Class: IP68 for outdoor installations
 EMC Standards: EN 55015, EN 61000 -3-2, EN 61000-4-2,3,4,5,6,11
 Safety Standards: EN 61347-1, EN 61347-2-13
 Over load Protection: over 100 % of rating, auto-recovery
 Short Circuit Protection: yes
 Over Voltage Protection: yes
 Withstanding Voltage: I-O:3,75 KVAC, I-FG: 2KVAC, O-FG 1,5 KVAC 1 minute
 Isolation Resistance: I-O, I-FG-O-FG: 100 M ohms/500 VDC
 100 % full load burn-in test: yes
 Body: Metal Case
 Warranty: 3 years
 Approvals: CE, CB, ENEC if required

ES

Grado de protección IP: IP68 para instalaciones de exterior
 Estándares para CEM: EN 55015, EN 61000 -3-2, EN 61000-4-2,3,4,5,6,11
 Estándares para seguridad: EN 61347-1, EN 61347-2-13
 Protección contra sobrecarga: Sí
 Protección contra cortocircuito: Sí
 Protección contra sobrevoltaje: Sí
 Voltaje resistente: I-O:3,75 KVAC, I-FG: 2KVAC, O-FG 1,5 KVAC 1 minuto
 Resistencia de aislamiento: I-O, I-FG-O-FG: 100 M ohms/500 VDC
 100% prueba de quemaduras a plena carga: Sí
 Cuerpo: Estuche de Metal
 Garantía: 3 años
 Aprobaciones: CE, CB, ENEC si se requiere

ENG

Electrostart JSCo is an independent European manufacturer of components for the lighting industry, established in 1967. Ever since providing the highest standards of products and customer service is the Electrostart's primary goal.

Today the company has a well-established supply chain in more than 40 countries worldwide. Our portfolio offers LED drivers, LED modules, project based solutions, electronic ballasts for fluorescent lamps, safety electronic transformers, magnetic ballasts for high intensity discharge lamps and components for the lighting control gear as well. All our products meet the latest design, reliability and energy-efficiency requirements. The lighting business environment is very dynamic and the present is the time for change to new more efficient and ecologically friendly lighting sources. Business environment changes as well and companies start to cooperate more in order to develop their product range. Electrostart has always tried to be close to its customers and provide solutions that meet the expectations of both the customer and final user.

More than 50 years we do business in responsible manner. All our actions are driven by the principles of professional competence, corporate honesty and transparency. We set up sustainable practices for corporate development and this is reflected in our integrated quality management system ISO 9001:2015, environmental policy tailored to ISO 14001:2015 and Occupational health & safety under OHSAS 18001:2007.

Electrostart's products comply with all applicable European Directives; they are tested and certified by VDE Germany, CENELEC AENOR Spain, Intertek.

ES

Electrostart JSCo es un fabricante europeo independiente de componentes para la industria de la iluminación desde el año 1967. La alta calidad de los productos y el servicio al cliente son el objetivo principal de Electrostart.

Hoy en día la empresa cuenta con una cadena de suministro bien establecida en más de 40 países de todo el mundo. Nuestro portafolio ofrece convertidores electrónicos para diodos emisores de luz, módulos LED, soluciones basadas en proyectos, balastos electrónicos para lámparas fluorescentes, transformadores electrónicos de seguridad, balastos magnéticos para lámparas de descarga a alta presión, tal como componentes para dispositivos de control de la iluminación. Todos nuestros productos cumplen con los últimos requisitos de diseño, fiabilidad y eficiencia energética.

El negocio en el sector de la iluminación es muy dinámico y ahora es el momento de cambiar las antiguas con nuevas, más eficientes y ecológicas fuentes de iluminación. El entorno empresarial también cambia y las empresas comienzan a cooperar más para desarrollar sus gamas de productos. Electrostart siempre ha tratado de estar cerca de sus clientes y ofrecer soluciones para satisfacer las necesidades de ambos tanto de los clientes, como de los usuarios finales.

Más de 50 años hacemos negocio de manera responsable. Todas nuestras acciones están impulsadas por los principios de la competencia profesional, la honestidad y la transparencia corporativa. Hemos creado las prácticas sostenibles para el desarrollo empresarial y esto se refleja en nuestro sistema de gestión de calidad ISO 9001:2015, la política ambiental adaptado a la norma ISO 14001:2015, Ocupacional y seguridad y salud en virtud de la norma OHSAS 18001:2007.

Nuestros productos cumplen con todas las directivas europeas aplicables y han sido aprobados y certificados por VDE - Alemania, CENELEC AENOR - España, Intertek.

**LED'S START UP THE LIGHT****Headquarters****Electrostart JSCo**

Bulgaria, Sofia 1404, 81, Bulgaria Blvd.
City General Business Center, building 2, floor 3, office 6
tel: + 359 2 400 77 71, fax: + 359 2 400 77 84

Registered office and Factory**Electrostart JSCo**

Bulgaria, Varshets 3540
2, Republika Blvd.
tel: + 359 2 400 70 11, fax: + 359 2 400 70 12